

CLIMATE CHANGE AND SITE PLANS

ADAPTATION SMART MANAGEMENT PRACTICES

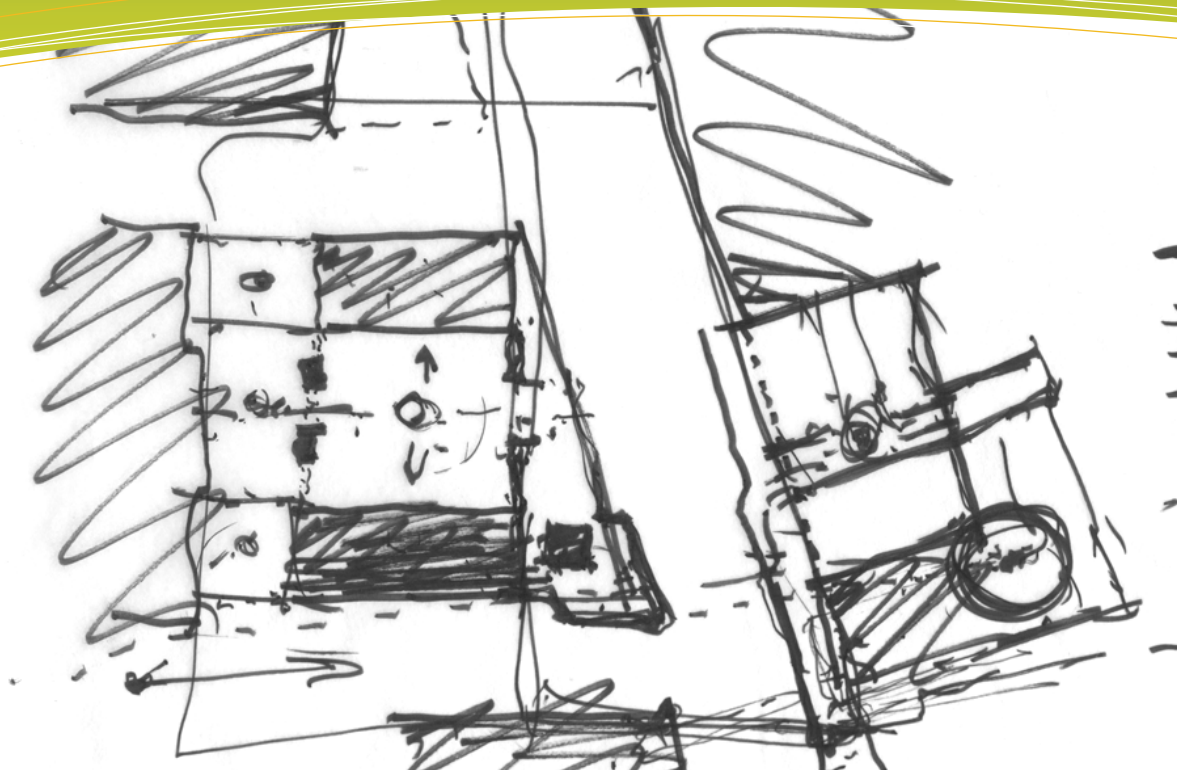

Climate Change Adaptation & Communities

Communities are on the frontlines of the
Climate Change Challenge.

A large development in your community like an office building, store or school can have a significant impact on your community. Be sure you have a comprehensive site plan review completed to minimize climate change impacts.

Can we help you with your climate change challenge?

Northwest Territories Association of Communities

Phone: (867) 873-8359 x 7

Fax: (867) 873-3042

E-mail: sara@nwtac.com

www.nwtac.com



Don't be shy about insisting that a comprehensive site plan review be completed. It becomes even more critical with climate change. Some things to consider are:

- Be sure that your Public Works Director and Fire Chief review the plans and provide comment.
- Do not hesitate to have an experienced northern engineer review the plan on your behalf. Pick an engineer that you are comfortable with and who knows your community and its potential climate change impacts.
- The cost can be recovered by adding those fees to your building permit fee.
- Have the building and site plan designers sign affidavits that they have duly considered climate change impacts in their design for the designated lifespan. This should be stamped by either the architect or engineer as appropriate.

Some things you might want to ensure you or your consultant have an opportunity to review:

- Drainage Plan both on or off the site. Review how it integrates with your Community Drainage Plan.
- Should the developer upgrade the ditches and sidewalks adjacent to their property? (Be sure that this is included in a potential requirement in your zoning or general plan)
- Grading and information on surfaces
- Snow storage
- If the building is large you may want to have wind tunnel testing completed
- All site planning should also consider climate change Impacts.

Be sure that your by-laws and forms reflect the new fees that might be required as part of your revised site plan process